

Utility Work (construction of storm sewer)

Flaggers will be utilized.
 Road open to East and West bound traffic.
 No signed Detour Route necessary.

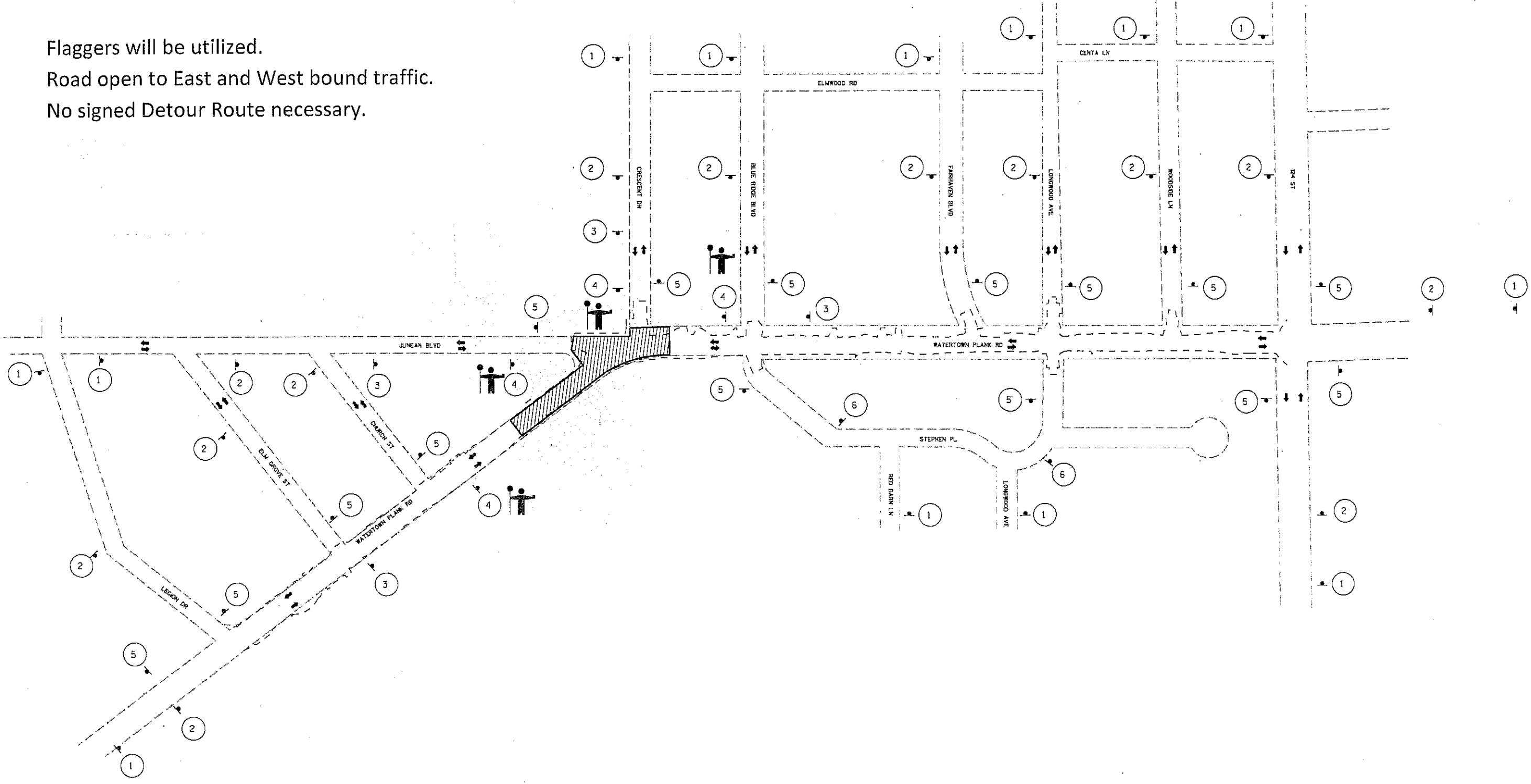

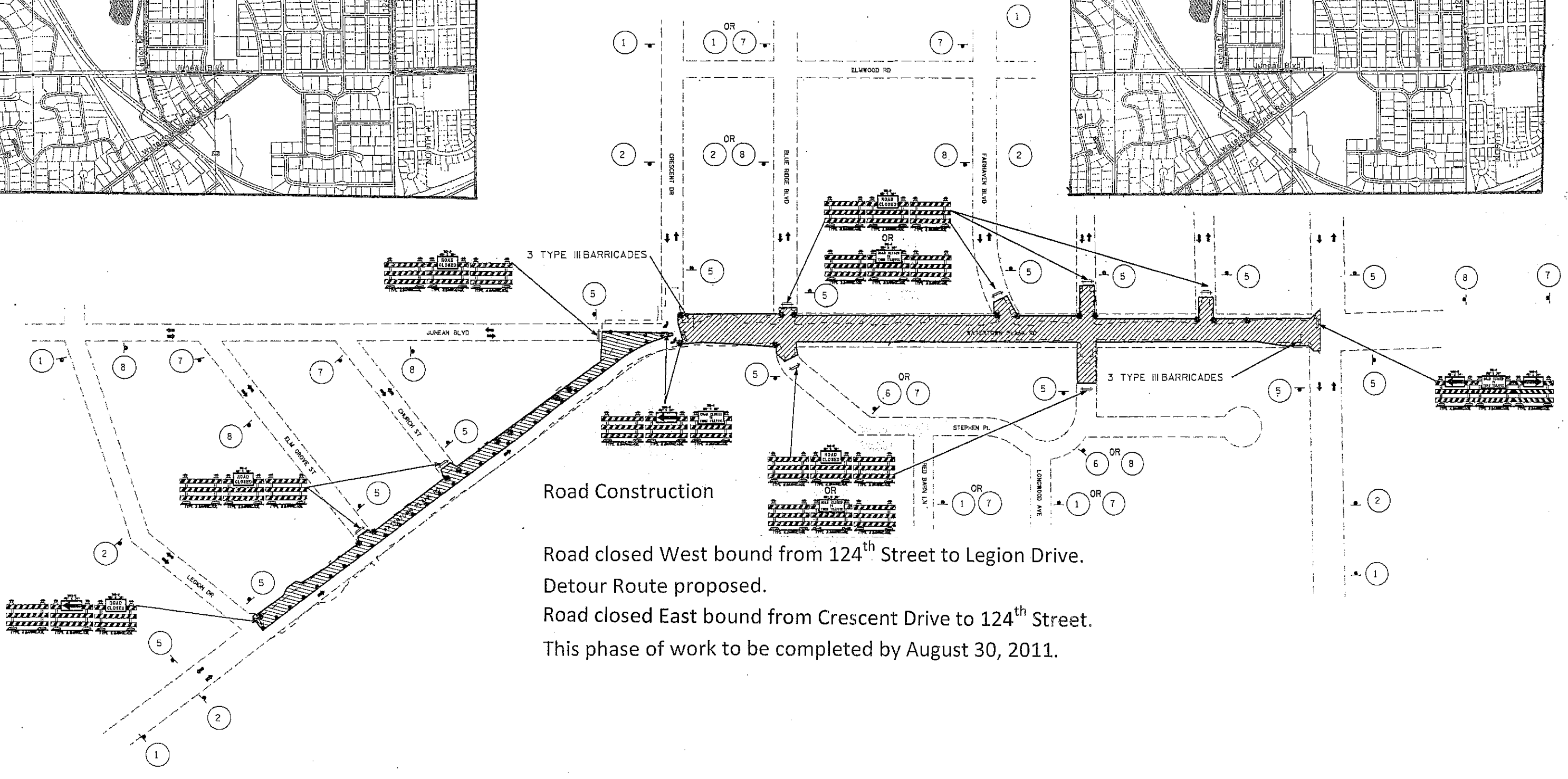
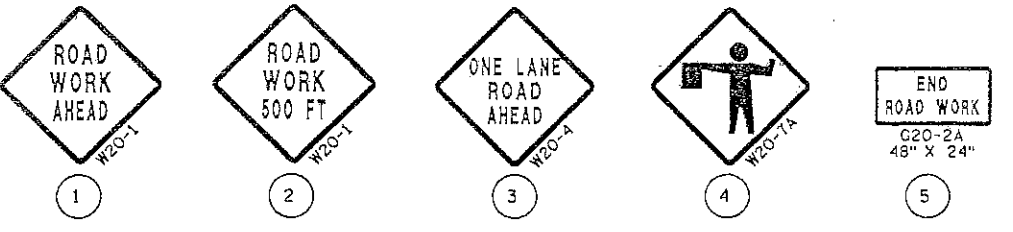
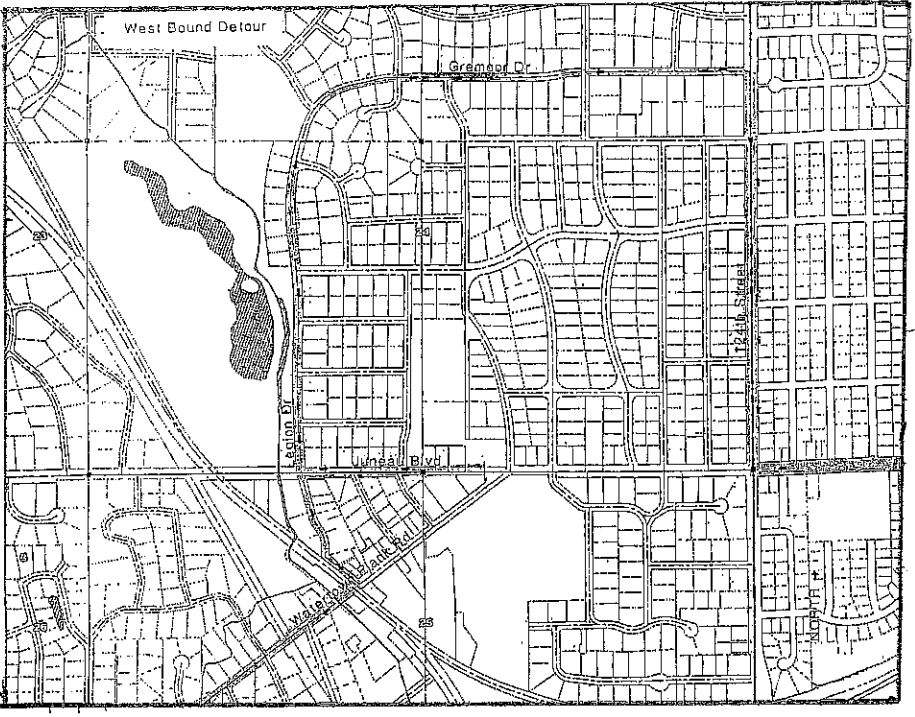
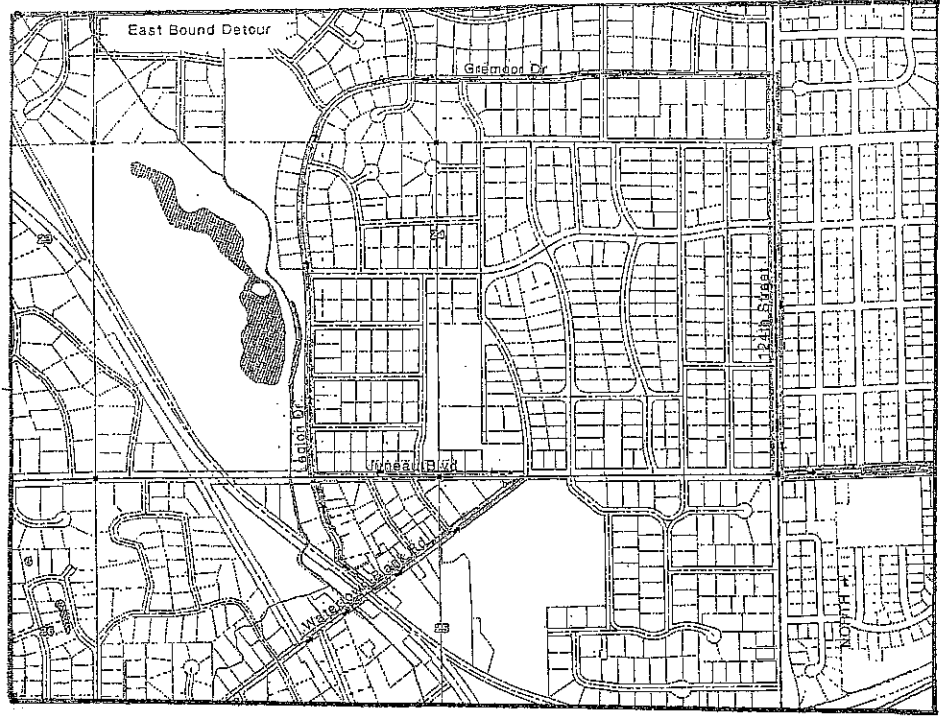

Road Construction

Road closed West bound from 124th Street to Legion Drive.
 Detour Route proposed.
 Road closed East bound from Crescent Drive to 124th Street.
 This phase of work to be completed by August 30, 2011.

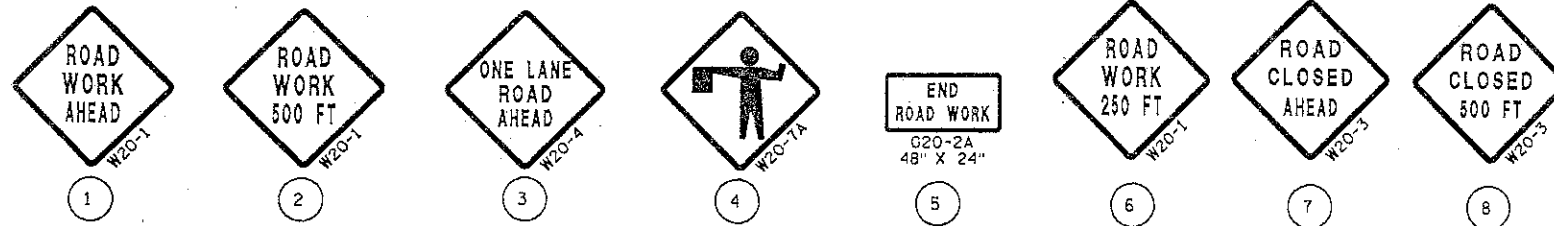
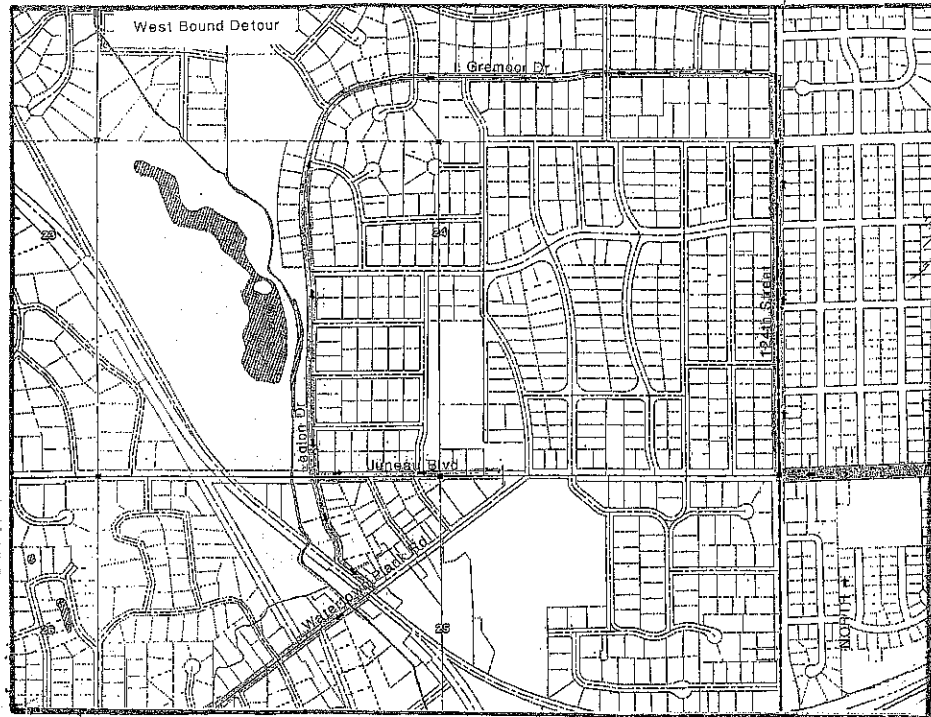

TYPE 2 BARRICADE
R9-9
24" X 12"
MOUNTED ON
TYPE 2 BARRICADE

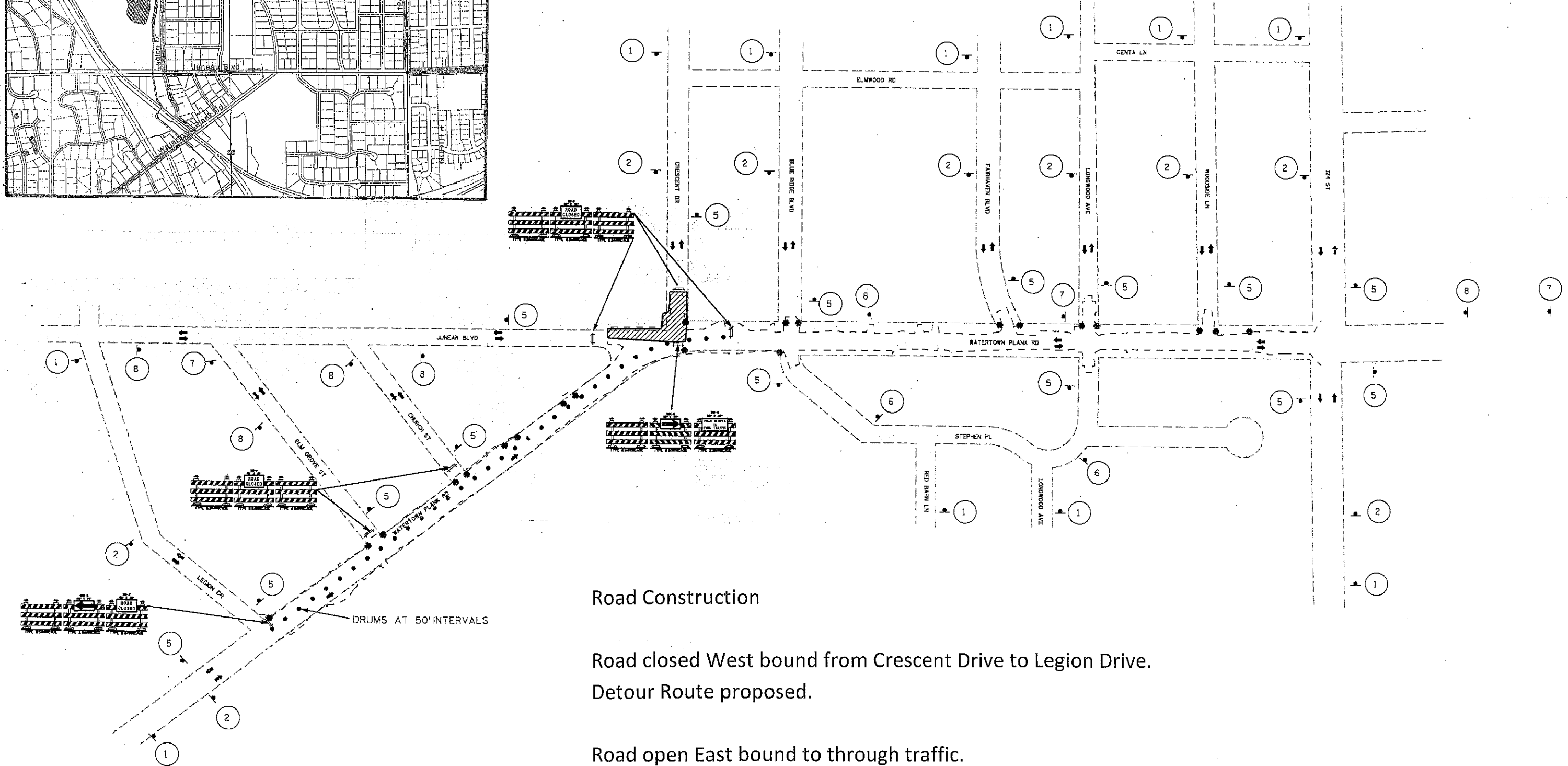

Road Construction

Road closed West bound from Crescent Drive to Legion Drive.
Detour Route proposed.

Road open East bound to through traffic.

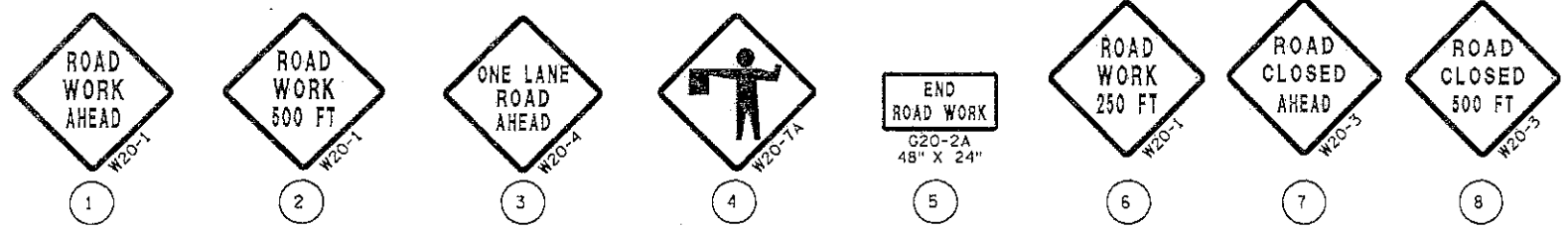
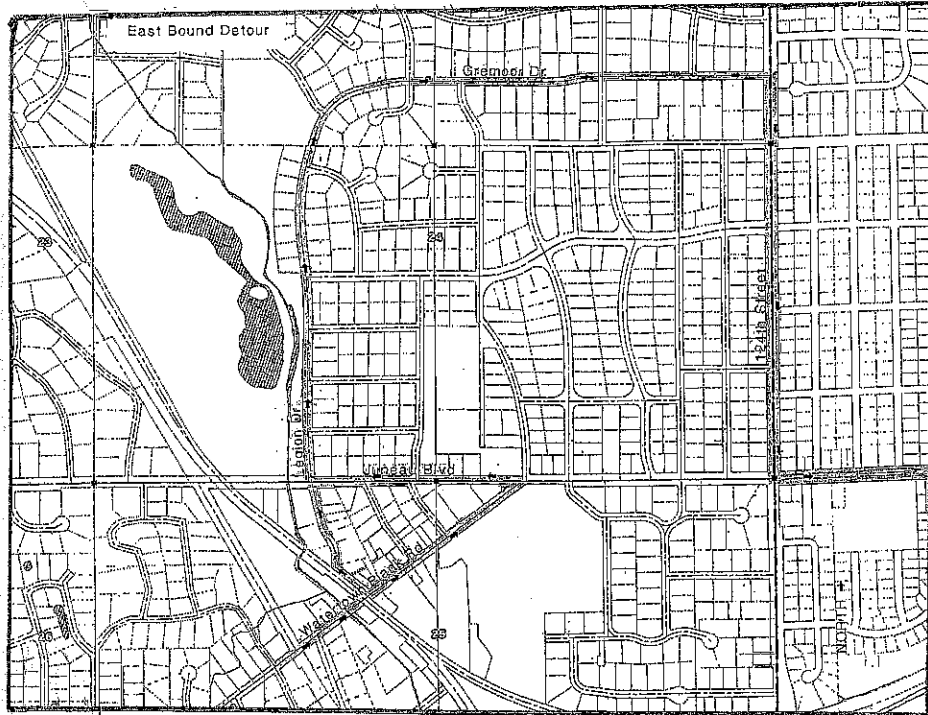

 FIREWALK CLOSED
 R9-9
 24" X 12"
 MOUNTED ON
 TYPE 2 BARRICADE

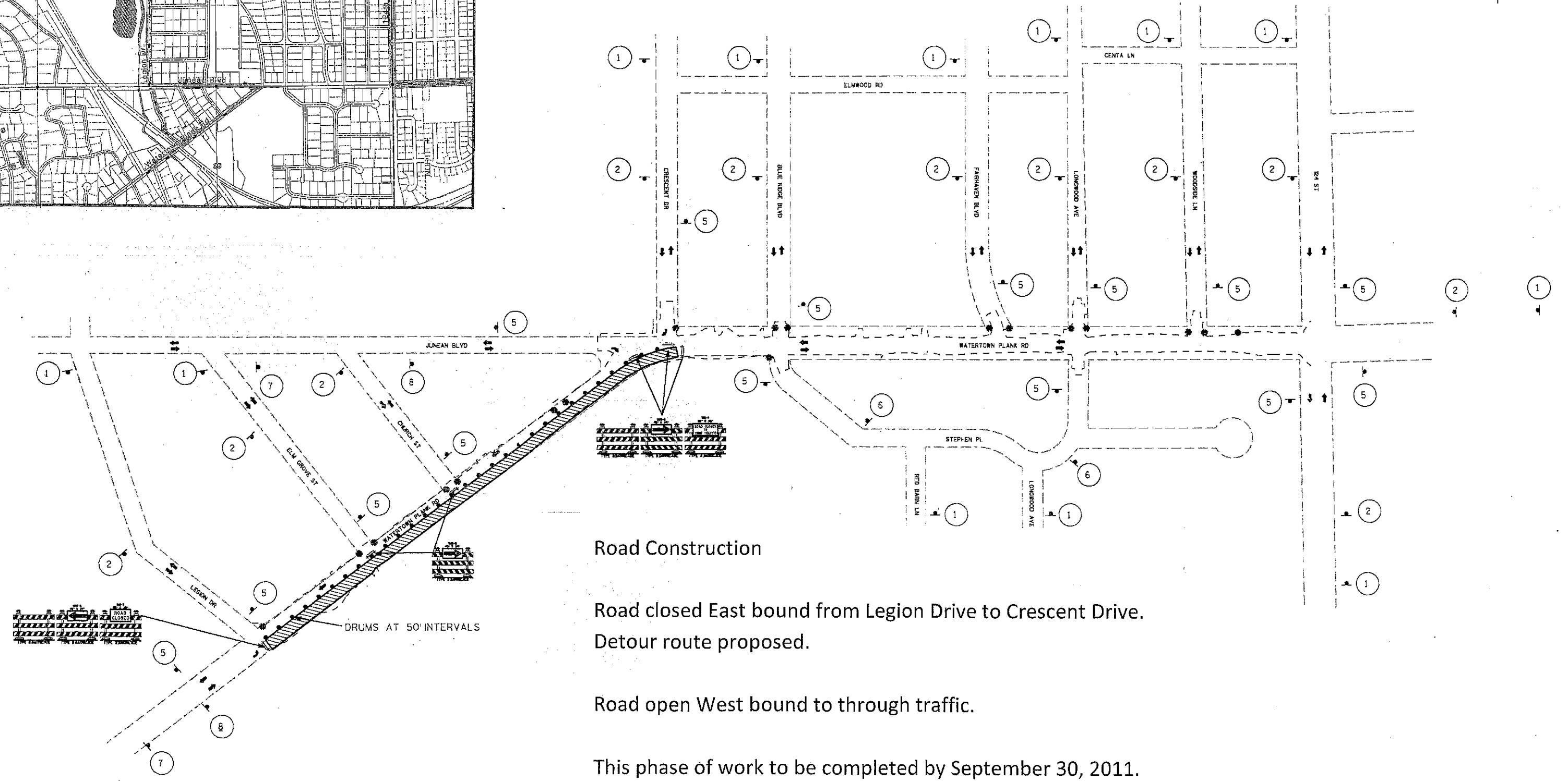

Road Construction

Road closed East bound from Legion Drive to Crescent Drive.
 Detour route proposed.

Road open West bound to through traffic.

This phase of work to be completed by September 30, 2011.

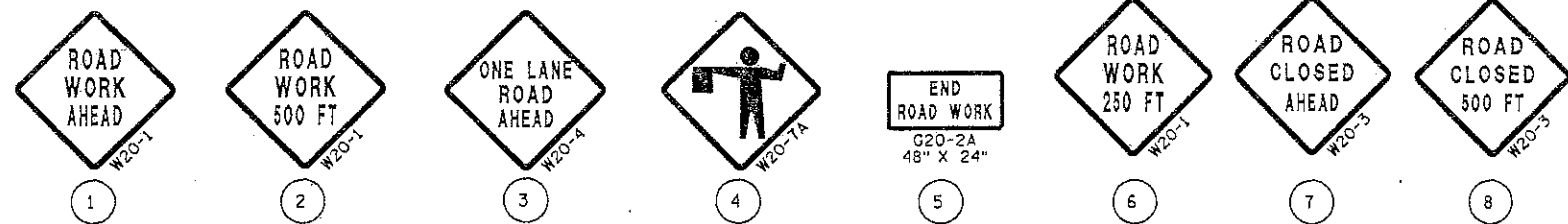

ROADWAY CLOSED
R9-9
24" X 12"
MOUNTED ON
TYPE 2 BARRICADE

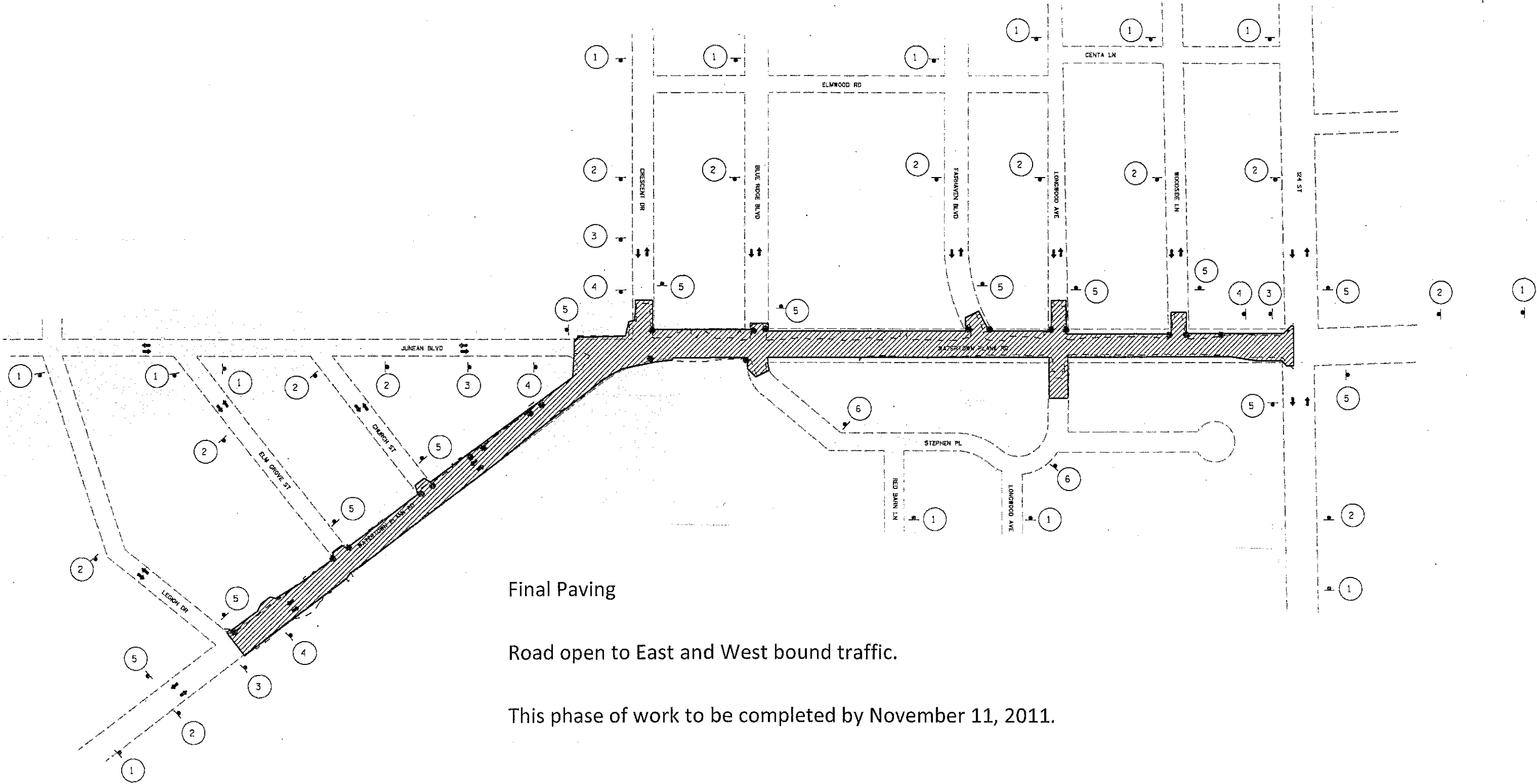

Final Paving

Road open to East and West bound traffic.

This phase of work to be completed by November 11, 2011.